

Polea Acero 1 Canal

Polea Acero Casquillo R10-Zinc Ø120 - Métrica 14

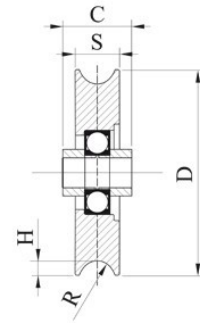

| Ref. | Ø | Métrica | Carga | Acabado | Unidades | C | H | S | Canal |
|----------|-----|---------|-------|---------|----------|----|---|----|-------|
| 1050 | 50 | 12 | 480 | Zinc | 30 | 25 | 9 | 15 | 10 |
| 1060M-12 | 60 | 12 | 480 | Zinc | 24 | 25 | 9 | 17 | 10 |
| 1060 | 60 | 14 | 480 | Zinc | 20 | 25 | 9 | 17 | 10 |
| 1070 | 70 | 14 | 480 | Zinc | 14 | 25 | 9 | 17 | 10 |
| 1080 | 80 | 14 | 480 | Zinc | 12 | 25 | 9 | 17 | 10 |
| 1090 | 90 | 14 | 480 | Zinc | 8 | 25 | 9 | 17 | 10 |
| 1100 | 100 | 14 | 480 | Zinc | 12 | 25 | 9 | 17 | 10 |
| 1120 | 120 | 14 | 480 | Zinc | 10 | 25 | 9 | 17 | 10 |
| 1140 | 140 | 16 | 600 | Zinc | 12 | 27 | 9 | 17 | 10 |
| 1150 | 150 | 16 | 600 | Zinc | 8 | 27 | 9 | 17 | 10 |
| 1160 | 160 | 16 | 600 | Zinc | 6 | 27 | 9 | 17 | 10 |
| 1180 | 180 | 16 | 600 | Zinc | 4 | 27 | 9 | 17 | 10 |
| 1200 | 200 | 16 | 600 | Zinc | 4 | 27 | 9 | 17 | 10 |
| 1220 | 220 | 16 | 600 | Zinc | 4 | 28 | 9 | 17 | 10 |
| 1250 | 250 | 16 | 600 | Zinc | 4 | 28 | 9 | 17 | 10 |

Fabricación según norma UNE-EN 13241-1-2004

CON TORNILLO

Ref. Ø Métrica Carga Acabado Unidades C H S Canal 2045 45 12 380 Zinc 20 25 9 17 10 2080 80 14 480 Zinc 10 25 9 17 10 2090 90 14 480 Zinc 14 25 9 17 10 2150 150 16 600 Zinc 8 27 9 17 10 2160 160 16 600 Zinc 6 27 9 17 10 2200 220 16 600 Zinc 4 28 9 17 10



2060 60 14 480 Zinc 20 25 9 17 10 2070 70 14 480 Zinc 14 25 9 17 10 2140 140 16 600 Zinc 12 27 9 17 10 2250 250 16 600 Zinc 4 28 9 17 10